

PARTS CATALOG

FRONT LOADER

PD MF L600 680-4 SHT S-0195

Code: 0501091405



Series: S-0195

Review: JANEIRO/95

**ORIGINAL PARTS
TATU**



INDEX

0909091299	1
0909091300	HYDRAULIC CIRCUIT	2

ATTENTION: IMPORTANT

MARCHESAN RESERVES THE RIGHT AT ANY TIME TO MAKE IMPROVEMENTS IN THE DESIGN, MATERIAL OR SPECIFICATIONS OF MACHINERY, EQUIPMENT OR PARTS WITHOUT THEREBY BECOMING LIABLE TO MAKE SIMILAR CHANGES IN MACHINERY, EQUIPMENT OR PARTS PREVIOUSLY SOLD.



Item	Code	Description	
18	0501010100	5/8" X 2" BOLT	06
19	0501012140	FLAT WASHER	10
20	0501011544	3/4" X 1-1/2" BOLT	06
21	0511016977		01
22	0501063958	1.5" X 4.3" PIVOT SHAFT LOCK	02
23	0501063959	PIVOT SHAFT	02
24	0501063751	1.5" X 5.5" PIVOT SHAFT	02
25	0503010962	5/8" X 1-1/4" BOLT	06
26	0503010002	GREASE FITTING	02
27	0501041849	1.1/4" NC X 910 ROD	01
27A	0501014914	1.1/4" X 910 ROD	01
27B	0501010087	1.1/4" UNC NUT	12
28	0501041427	1.1/4" NC X 1540 ROD	02
28A	0501014250	1.1/4" X 1540 ROD	01
28B	0502012180	CONICAL SPRING WASHER	02
29	0531017226		02
30	0108010002	9 TEETH ROOTH RAKER	02
30A	0501060958	9 TEETH ROOTH RAKER	01
30B	0501010276	1" X 3" BOLT	04
30C	0501010623	FLAT WASHER	04
30D	0503010012	1" SPRING WASHER	04
30E	0503010059	33287/33462 ROLLER BEARING	04
31	0501010500	3/4" X 3" BOLT	04
32	0503010023	3/4" SPRING WASHER	18
33	0503010014	3/4" NUT	04
34	0501018059	3/4" X 2-1/4" BOLT	08
35	0503011102	7/16" X 1-1/4" BOLT	04
36	0503010180	7/16" SPRING WASHER	04

HYDRAULIC CIRCUIT

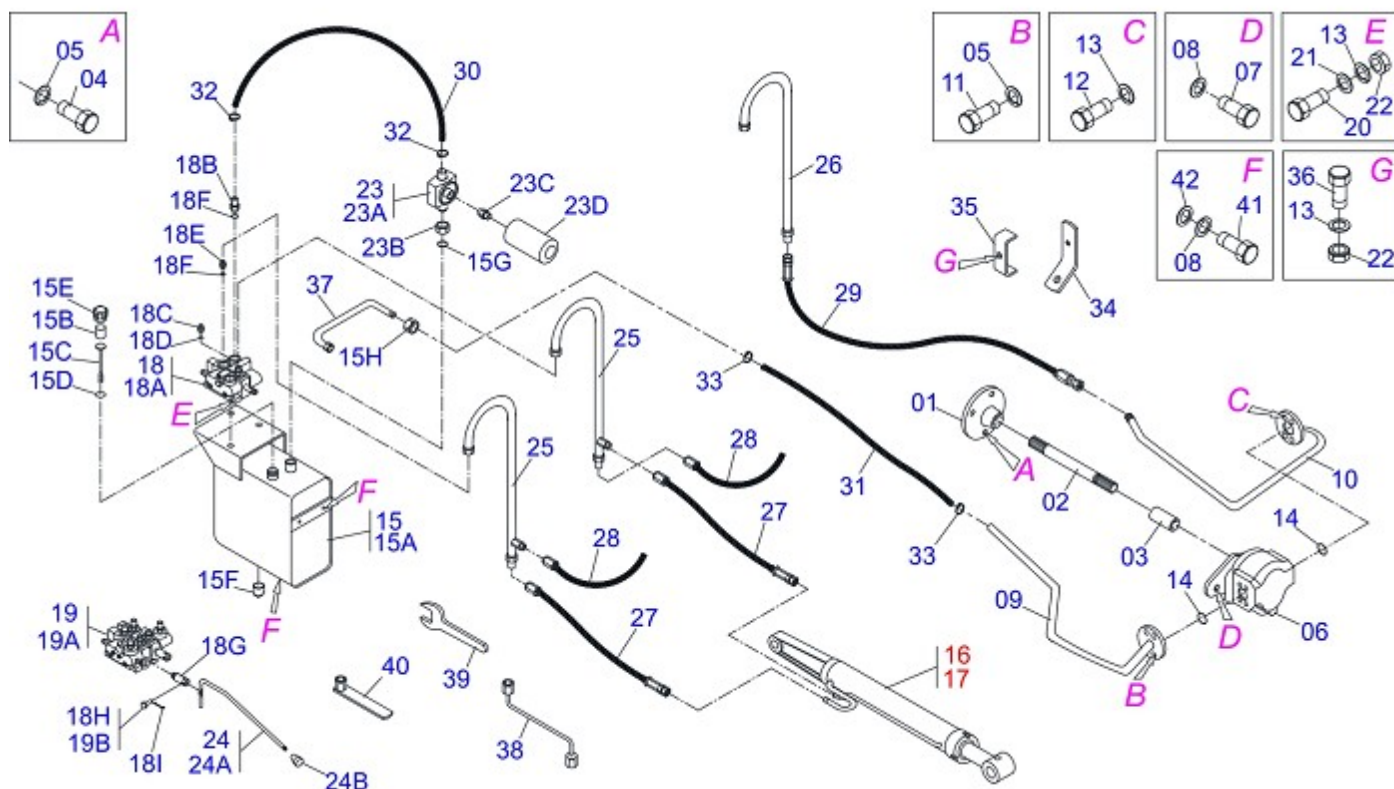

Item	Code	Description	CS	CD
01	0503050056	FLANGE COUPLING	01	01
02	0503030881	695 X 1.1/8 STRIATED X 1.1/8-30G AXLE	01	01
03	0503030838	1-1/8" X 2.4" SLEEVE	01	01
04	0503010119	7/16" X 1-1/4" BOLT	04	04
05	0503010180	7/16" SPRING WASHER	08	08
06	0503060153	40L 1/2" PUMP	01	01
07	0503010920	1/2" X 1.1/2" BOLT	02	02
08	0503010019	1/2" SPRING WASHER	06	06
09	0501066833	PUMP SUCTION TUBE	01	01
10	0501066832	PUMP PRESSURE TUBE	01	01
11	0503010355	7/16" X 1" BOLT	04	04
12	0503010237	3/8" X 1" HEX BOLT G5	04	04
13	0503010025	3/8" SPRING WHASHER	04	04
14	0503010173	2-220 N 3006-9B O'RING	02	02
15	0501047808	RESERVOIR OIL ASSY	01	01
15A	0501068882	RESERVOIR OIL	01	01
15B	0503030044	FILTERING ELEMENT	01	01
15C	0501060975	OIL GAGE	01	01
15D	0503010185	2-221 N 3006-9B O'RING	01	01
15E	0502020475	WHEEL HUB	01	01
15F	0503031604	1/2" BSP PLUG	01	01
15G	0503010046	2-216 N 3006-9B O'RING	01	01
15H	0501016309	2" 1X 2.5/16" NUT	01	01
16	0501040161	RIGHT HYDRAULIC CYLINDER	01	01
17	0501040162	LEFT HYDRAULIC CYLINDER	01	01
18	0501040871	1/2" COMMAND SIMPLE ASSY	01	01
18A	0503060080	1/2" COMMAND SIMPLE	01	
18B	0501010591	HOSE NIPPLE	01	01
18C	0501010589	1-1/16 NIPPLE	01	01
18D	0503010602	2-211 N 3006-9B O'RING	02	02
18E	0501010590	7/8" REDUCTION NIPPLE	02	04
18F	0503010045	2-116 N 3006-9B O'RING	02	04
18G	0503030347	UPPER LEVER ASSY (SAUER DANFOSS)	01	02



HYDRAULIC CIRCUIT

0909091300

Item	Code	Description	CS CD
18H	0503010593	2-154 N 3000-7B O'RING	01
18I	0503010140	1/8" X 3/4" COTTERPIN	01 02
19	0501040873	1/2" DOUBLE COMMAND	01 01
19A	0503060081	1/2" DOUBLE COMMAND	01
19B	0521010532	0.3" X 0.9" COUPLING SHAFT	02
20	0501010080	3/8" X 1-1/2" BOLT	03 03
21	0501010984	FLAT WASHER	03 03
22	0503010026	3/8" NUT	04 04
23	0501041108	RETURNING FILTER ASSY	01 01
23A	0502050002	RETURNING FILTER HEAD	01 01
23B	0501010594	1" NUT HEX	01 01
23C	0501010595	1" NF NIPPLE	01 01
23D	0503010183	RETURNING FILTER	01 01
24	0501045092	CONTROL LEVER ASSY	01 02
24A	0501067116	CONTROL LEVER ASSY	01 01
24B	0503030878	LEVER CRANK	01 01
25	0501068945	CURVED CONNECTION	02 02
26	0501064350	VALVE PRESSURE TUBE	01 01
27	0501080033		02 02
28	0501080102	1/2" X 2200 TR-TR HOSE	02 02
29	0501080202		01 01
30	0501013822	1" X 25.6" AB-AB HOSE	01 01
31	0501013823		01 01
32	0503010184	1-1/4" TO 1-1/2" CLAMP	02 02
33	0503010243	1-1/2" TO 2" CLAMP	02 02
34	0511014792		01 01
35	0511012725	CLAMP DISTRIBUTOR OIL	01 01
36	0501011048	3/8" X 2-1/2" BOLT	01 01
37	0501067815	TANK OUTER TUBE	01 01
38	0501068213	5/8" WRENCH DOUBLE	01 01
39	0511010153	2-5/16" FIXED WRENCH	01 01
40	0501061617	1" WRENCH CYLINDRICAL HEX	01 01
41	0501010161	1/2" X 1-1/4" BOLT	04 04
42	0511017302	FLAT WASHER	04 04



MARCHESAN

MARCHESAN IMPLEMENTOS E MÁQUINAS AGRÍCOLAS TATU S.A.

AV. Marchesan, 1979 - Post office box, 131 - CEP 15994-900 - Matão - SP - Brazil

Phone +55 16.3382-8282

(FAX Parts) + 55 16.3382. 8297 - (Export) + 55 16.3382.1003

e.mail: tatu@marchesan.com.br www.marchesan.com.br

Drafting and Illustration = GASPARI
e.mail = jgaspari@marchesan.com.br

**ORIGINAL PARTS
TATU**



MARCHESAN