

PARTS CATALOG

FRONT LOADER

PD MF 290-4/TL SHT S-0198

Code: 0501091398



Series: S-0198

Review: JANEIRO/98

ORIGINAL PARTS
TATU



INDEX

0909091033	FRONT LOADER MF 290-4/TL SHT S-0198	1
0909091034	HYDRAULIC CIRCUIT MF 290-4	2

ATTENTION: IMPORTANT

MARCHESAN RESERVES THE RIGHT AT ANY TIME TO MAKE IMPROVEMENTS IN THE DESIGN, MATERIAL OR SPECIFICATIONS OF MACHINERY, EQUIPMENT OR PARTS WITHOUT THEREBY BECOMING LIABLE TO MAKE SIMILAR CHANGES IN MACHINERY, EQUIPMENT OR PARTS PREVIOUSLY SOLD.

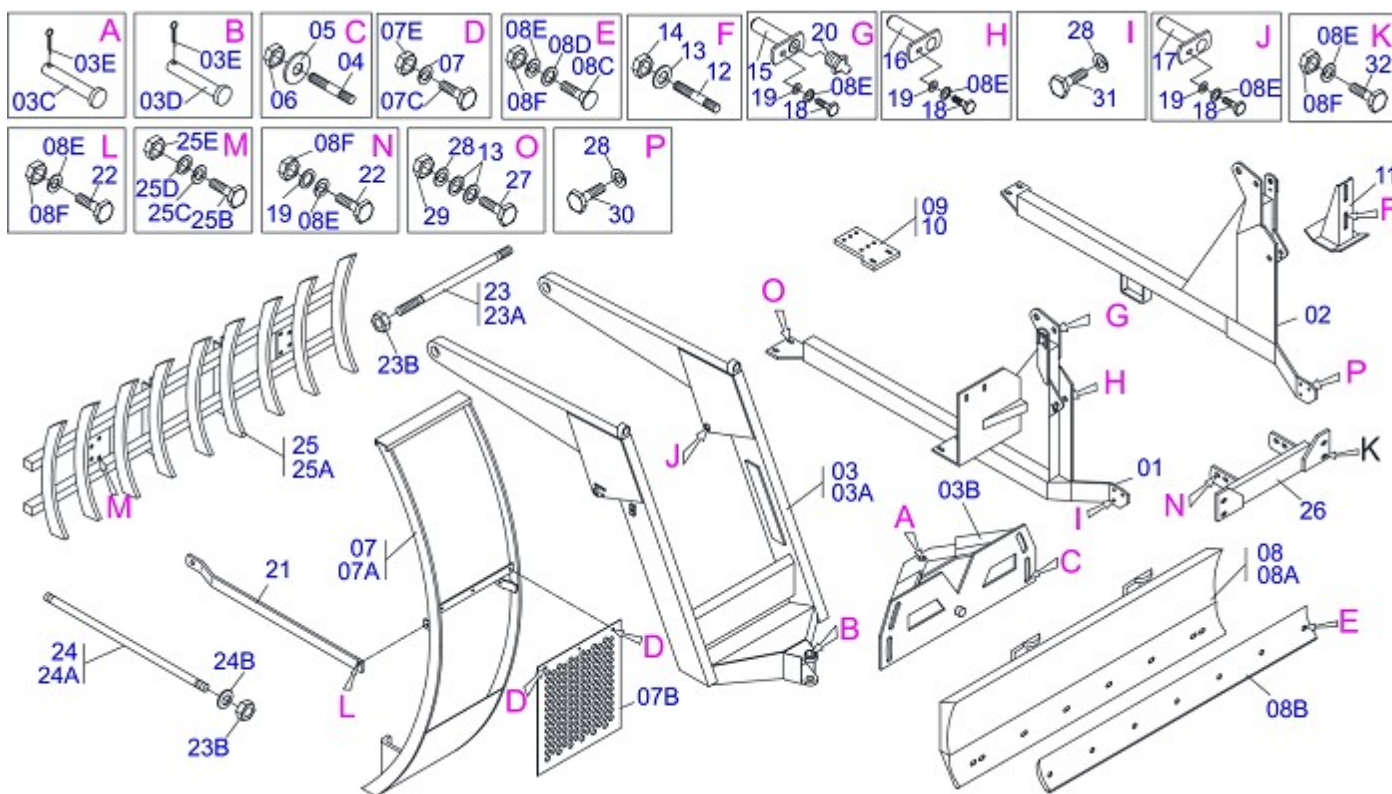

Item	Code	Description	QT
01	0501069138	RIGHT FRAME	01
02	0501069139	LEFT FRAME	01
03	0501047979		01
03A	0501069170		01
03B	0501062637	5/8" REGULATOR SUPPORT	01
03C	0521010618	1.4" X 8.6" COUPLING SHAFT	01
03D	0501010612	CONTROL VALVE LEVER	01
03E	0503010010	1/4" X 2.1/2" COTTERPIN	02
04	0501010572	1 UNC X 1 UNS X 76 PRISONER	04
05	0501010574	FLAT WASHER	04
05A	0501067999	2390 BLADE SUPPORT	01
05B	0622360018	SCRAPER 940 STA-2-3	01
05C	0501012240	5/8" X 2-1/2" BOLT	08
05D	0501010301	FLAT WASHER	20
05E	0503010027	5/8" SPRING WASHER	20
06	0503010340	1" UNF NUT	04
07	0501047978		01
07A	0501069169		01
07B	0501014214		01
07C	0503010751	3/8" X 1.1/4" HEX BOLT G.5	03
07D	0501010984	FLAT WASHER	03
07E	0503010026	3/8" NUT	03
08	0501047708	2400 BLADE SUPPORT	01
08A	0501067999	2390 BLADE SUPPORT	01
08B	0622360016	94.5" SCRAPER REVERSIBLE	01
08C	0501012240	5/8" X 2-1/2" BOLT	08
08D	0501010301	FLAT WASHER	08
08E	0503010027	5/8" SPRING WASHER	24
08F	0503010013	5/8" NUT	18
09	0501064690		01
10	0501064689		01
11	0501063411	ESTABILIZER BRACKET	02
12	0501010571	3/4 NC X 3/4 NF X 56 PRISONER	04



FRONT LOADER MF 290-4/TL SHT S-0198

0909091033

Item	Code	Description	QT
13	0501010322	FLAT WASHER	12
14	0503010335	3/4" NUT	04
15	0501063958	1.5" X 4.3" PIVOT SHAFT LOCK	02
16	0501063959	PIVOT SHAFT	02
17	0501063751	1.5" X 5.5" PIVOT SHAFT	02
18	0503010962	5/8" X 1-1/4" BOLT	06
19	0501012140	FLAT WASHER	10
20	0503010002	GREASE FITTING	02
21	0511014684		02
22	0501010100	5/8" X 2" BOLT	06
23	0501042819	1.1/4"NC X 33.46" ROD	01
23A	0501018845	1.1/4" X 33.46" ROD	01
23B	0501010087	1.1/4" UNC NUT	04
24	0501041427	1.1/4" NC X 1540 ROD	02
24A	0501014250	1.1/4" X 1540 ROD	01
24B	0502012180	CONICAL SPRING WASHER	02
25	0108010002	9 TEETH ROOTH RAKER	01
25A	0501060958	9 TEETH ROOTH RAKER	01
25B	0501010276	1" X 3" BOLT	04
25C	0501010065	FLAT WASHER	04
25D	0503010012	1" SPRING WASHER	04
25E	0501010059	1" NUT HEX	04
26	0501064510		01
27	0501010500	3/4" X 3" BOLT	04
28	0503010023	3/4" SPRING WASHER	04
29	0503010014	3/4" NUT	04
30	0501010098	3/4" X 2" BOLT	04
31	0501010125	3/4" X 2-1/2" BOLT	02
32	0503010233	5/8" X 2-1/2" BOLT	04

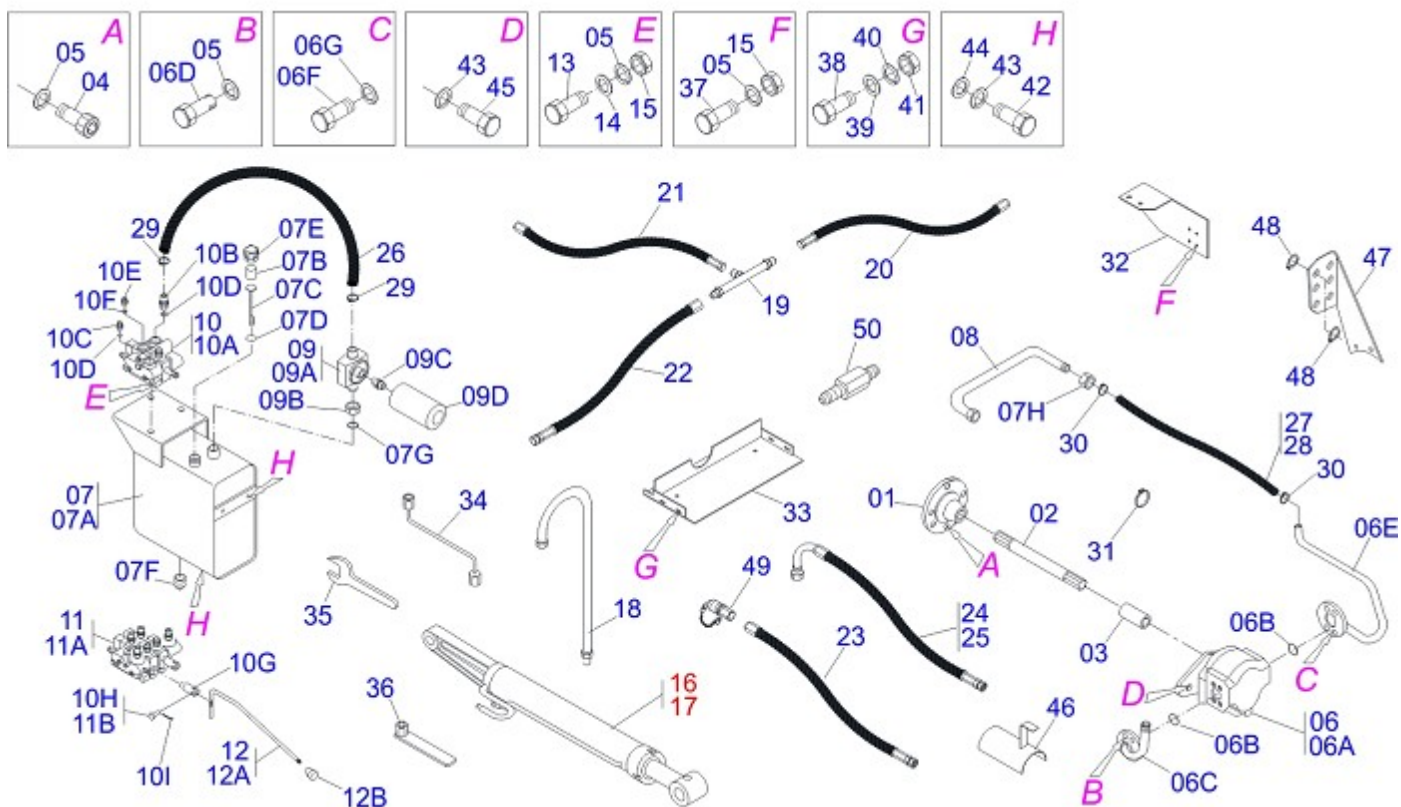

Item	Code	Description	CS	CD
01	0503050003	COUPLING FLANGE	01	01
02	0501068938	15" X 1.1/8 AXLE STRIATED	01	01
03	0503030838	1-1/8" X 2.4" SLEEVE	01	01
04	0503010175	3/8" X 1-1/4" BOLT	06	06
05	0503010025	3/8" SPRING WHASHER	17	17
06	0501052129	PUMP WITH TUBE	01	01
06A	0503060045	40L 1/2" PUMP	01	01
06B	0503010173	2-220 N 3006-9B O'RING	02	02
06C	0501069661	PUMP PRESSURE TUBE	01	01
06D	0503010237	3/8" X 1" HEX BOLT G5	04	04
06E	0501069536	PUMP SUCTION TUBE	01	01
06F	0503010355	7/16" X 1" BOLT	04	04
06G	0503010180	7/16" SPRING WASHER	04	04
07	0501047808	RESERVOIR OIL ASSY	01	01
07A	0501068882	RESERVOIR OIL	01	01
07B	0503030044	FILTERING ELEMENT	01	01
07C	0501060975	OIL GAGE	01	01
07D	0503010185	2-221 N 3006-9B O'RING	01	01
07E	0502020472	TANK COVER BODY	01	01
07F	0503031604	1/2" BSP PLUG	01	01
07G	0503010046	2-216 N 3006-9B O'RING	01	01
07H	0501016309	2" 1X 2.5/16" NUT	01	01
08	0501063383	TANK OUTER TUBE	01	01
09	0501041108	RETURNING FILTER ASSY	01	01
09A	0502050002	RETURNING FILTER HEAD	01	01
09B	0501010594	1" NUT HEX	01	01
09C	0501010595	1" NF NIPPLE	01	01
09D	0503010183	RETURNING FILTER	01	01
10	0501040871	1/2" COMMAND SIMPLE ASSY	01	
10A	0503060080	1/2" COMMAND SIMPLE	01	
10B	0501010591	HOSE NIPPLE	01	01
10C	0501010589	1-1/16 NIPPLE	01	01
10D	0503010602	2-211 N 3006-9B O'RING	02	02



PD MF 290-4/TL SHT S-0198
HYDRAULIC CIRCUIT MF 290-4

Item	Code	Description	CS CD
10E	0501010590	7/8" REDUCTION NIPPLE	02 04
10F	0503010045	2-116 N 3006-9B O'RING	02 04
10G	0503030347	UPPER LEVER ASSY (SAUER DANFOSS)	01 02
10H	0501010593	0.3" X 1" X 1/2" X 1.1 PIN	01
10I	0503010140	1/8" X 3/4" COTTERPIN	01 02
11	0501040873	1/2" DOUBLE COMMAND	01
11A	0503060081	1/2" DOUBLE COMMAND	01
11B	0521010532	0.3" X 0.9" COUPLING SHAFT	02
12	0501047852	CONTROL VALVE (PD V 118 SHT)	01 02
12A	0501069069	CONTROL VALVE (V 985-4/AX 4.75)	01 01
12B	0503030878	LEVER CRANK	01 01
13	0501010080	3/8" X 1-1/2" BOLT	01 02
14	0501010984	FLAT WASHER	01 02
15	0503010026	3/8" NUT	01 02
16	0501044368	HYDRAULIC CYLINDER	01 01
17	0501044369	HYDRAULIC CYLINDER	01 01
18	0501064350	VALVE PRESSURE TUBE	01 01
19	0501068942	"T" CONNECTION NIPPLES	02 02
20	0501080109	1/2" X 800 TR-TR HOSE	02 02
21	0501080103	1/2" X 47" TR-TR HOSE ASSY	02 02
22	0501080052	1/2" X 63" TR-TR HOSE ASSY	02 02
23	0501080308		01
24	0501080402	3/8" X 67" TR-TC HOSE ASSY	01
25	0501080708		01
26	0501013822	1" X 25.6" AB-AB HOSE	01 01
27	0501011513	1.1/4" X 1100 AB-ABROSE	01
28	0501010808	1.1/4" X 1300 AB-AB HOSE	01
29	0503010184	1-1/4" TO 1-1/2" CLAMP	02 02
30	0503010243	1-1/2" TO 2" CLAMP	02 02
31	0503010246	2" TO 2 1/2" CLAMP	02 02
32	0521017643	FILTER SUPPORT	01 01
33	0501069729		01 01
34	0501068213	5/8" WRENCH DOUBLE	01 01
35	0511010153	2-5/16" FIXED WRENCH	01 01
36	0501061617	1" WRENCH CYLINDRICAL HEX	01 01
37	0503010751	3/8" X 1.1/4" HEX BOLT G.5	04 04
38	0503010743	1/4" X 1-1/4" BOLT	04 04
39	0511017303	FLAT WASHER	04 04
40	0503010143	1/4" SPRING WASHER	04 04
41	0503010144	1/4" NUT	04 04
42	0501010161	1/2" X 1-1/4" BOLT	04 04
43	0503010019	1/2" SPRING WASHER	06 06
44	0511017302	FLAT WASHER	04 04
45	0503010920	1/2" X 1.1/2" BOLT	02 02
46	0511064563	HOSE PROTECTION	01 01
47	0511019730	QUICK COUPLING SUPPORT	01
48	0503010217	501040 CLAMPING RING (FOR AXLE)	04
49	0501053835	FEMALE QUICK COUPLER	02
50	0521014428	EXTENSION HEX	02 02



MARCHESAN

MARCHESAN IMPLEMENTOS E MÁQUINAS AGRÍCOLAS TATU S.A.

AV. Marchesan, 1979 - Post office box, 131 - CEP 15994-900 - Matão - SP - Brazil

Phone +55 16.3382-8282

(FAX Parts) + 55 16.3382. 8297 - (Export) + 55 16.3382.1003

e.mail: tatu@marchesan.com.br www.marchesan.com.br

*Drafting and Illustration = GASPARI
e.mail = jgaspari@marchesan.com.br*

**ORIGINAL PARTS
TATU**



MARCHESAN